

p. 208 MCD' HSK-A63 F.26 RL

PCLNR/L 065.12
PDJNR/L 070.15
SVHBR/L 065.16

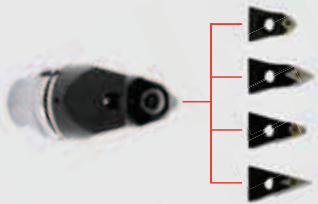

p. 209 MCD' HSK-A63 F.77 N

PCMNN 130.12
PDNNN 140.15
SRDCN 130.12
SVVBN 140.16

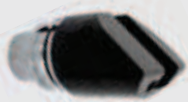

p. 210 MCD' HSK-A63 TU 20.45R/L



p. 210 MCD' HSK-A63 TU 25.02N



p. 211 MCD' HSK-A63 D.32X64
MCD' HSK-A63 D.40X85



Milling and turning operations

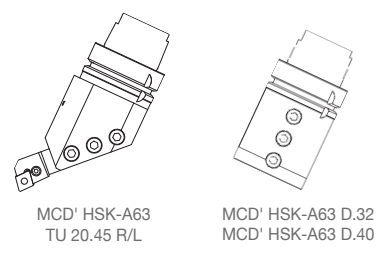
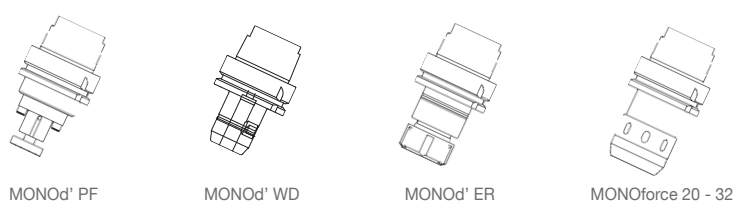
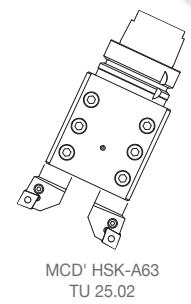
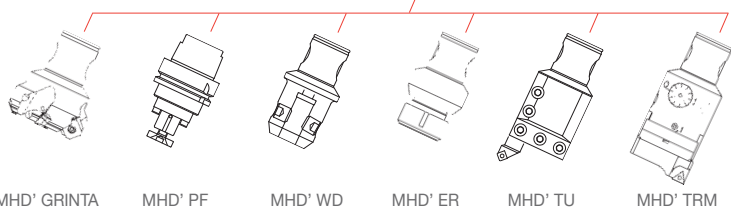
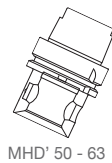

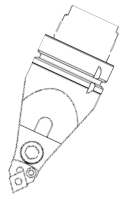

MCD' HSK-A63F.77
PCMNN 130.12

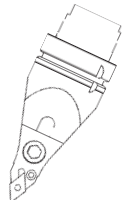

MCD' HSK-A63F.77
PDNNN 140.15

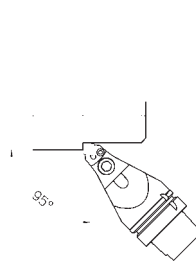

MCD' HSK-A63 F.77
PCMNN 130.12

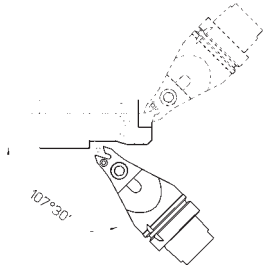

MCD' HSK-A63 F.77
PDNNN 140.15

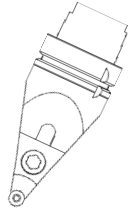

MCD' HSK-A63 F.77
SRDCN 130.12

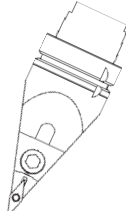

MCD' HSK-A63 F.77
SVVBN 140.16

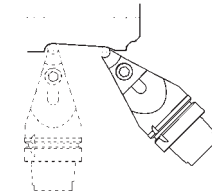

MCD' HSK-A63 F.77
SRDCN 130.12

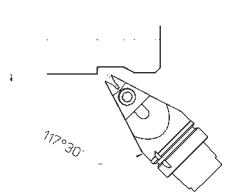

MCD' HSK-A63 F.77
SVVBN 140.16

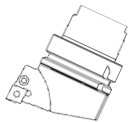

MCD' HSK-A63 F.26
PCLNR/L 065.12

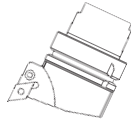

MCD' HSK-A63 F.26
PDJNR/L 070.15

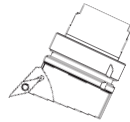

MCD' HSK-A63 F.26
SVHBR/L 065.16

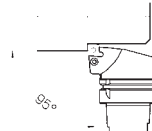

MCD' HSK-A63 F.26
PCLNR/L 065.12

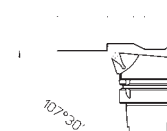

MCD' HSK-A63 F.26
SVHBR/L 065.16

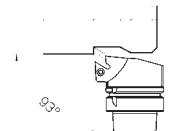

MCD' HSK-A63 F.26
PDJNR/L 070.15

- TURNING TOOLS
- DREHENWERKZEUGE
- UTENSILIOS PARA TORNEADO
- OUTILS DE TOURNAGE
- UTENSILI DI TORNITURA

GB MCD' is the line of tools and tool holders for lathes, built according to HSK-A63 and HSK-T63 standards with recommended ICTM constructive tolerances (ISO 12164-3) for the application on spindles of MULTI-TASK machinery. The MCD' program is produced in modular version, and is composed of toolholders with HSK coupling module and interchangeable bit holders. The range includes toolholders which permit the mounting of tools for internal, external, cutting and threading of the various standard programs on the market

D MCD' ist eine Werkzeug- und Werkzeughalterlinie für Drehmaschinen nach den Normen HSK-A63 und HSK-T63 mit ICTM-Bautoleranzen (ISO 12164-3), die für die Anbringung auf den Spindeln von MULTI-TASK-Maschinen empfohlen werden. Das MCD' Programm wird in modularer Ausführung hergestellt und besteht aus Werkzeughaltern mit HSK Anschluss und austauschbaren Einsatzhaltern. Das Produktangebot umfasst auch Werkzeughalter, die die Montage von Werkzeugen für die Innen- und Außenbearbeitung, für Schnitt und Gewindebearbeitung der verschiedenen, auf dem Markt erhältlichen Standardprogramme ermöglichen.

E MCD' es la línea de herramientas y portaherramientas para torno, realizados conforme a las normas HSK-A63 y HSK-T63 con tolerancias de construcción ICTM (ISO 12164-3) recomendadas para la aplicación en husillos de máquinas MULTI-TASK. El programa MCD' se realiza en versión modular y está compuesto por portaherramientas con acoplamiento HSK y asientos portaplaquitas intercambiables. La gama presenta portaherramientas que permiten el montaje de herramientas para el mecanizado interno, externo, corte y roscado de los diferentes programas estándar disponibles en el mercado.

F MCD' est la ligne d'outils et porte-outils pour le tour, réalisés selon les normes HSK-A63 et HSK-T63 avec des tolérances de fabrication ICTM (ISO 12164-3) recommandées pour l'application sur les broches des machines MULTI-TASK. Le programme MCD' est produit en version modulaire et est composé de porte-outils avec mandrin HSK et logements porte-plaquette interchangeables. La gamme est complétée par le porte-outils permettant l'installation d'outils pour intérieurs, extérieurs, le découpage et le filetage des différents programmes standard existants sur le marché.

I MCD' è la linea di utensili e portautensili da tornio, realizzati seguendo le norme HSK-A63 e HSK-T63 con tolleranze costruttive ICTM (ISO 12164-3) raccomandate per l'applicazione sui mandrini di macchine MULTI-TASK. Il programma MCD' è prodotto in versione modulare, ed è composto da portautensili con attacco HSK e seggi porta inserto intercambiabili. La gamma è completa di portautensili che permettono il montaggio di utensili per interni, esterni, taglio e filettatura dei vari programmi standard esistenti sul mercato.

MCD' D'ANDREA

- TURNING TOOLS
- DREHENWERKZEUGE
- UTENSILIOS PARA TORNEADO
- OUTILS DE TOURNAGE
- UTENSILI DI TORNITURA

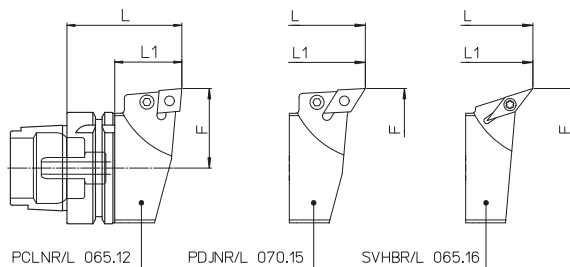

- Supplied with coolant tube. Without bit-holders and clamping wrenches
- Lieferung inklusive Kühlmittelrohr. Sitze und Anzugsschlüssel nicht inbegriffen
- Completo con racor para el refrigerante. No incluye los asientos ni las llaves de apriete
- Pourvu de raccord pour liquide d'arrosage. Logements et vis de serrage exclus
- Completo di raccordo per il refrigerante. Seggi e chiavi di serraggio esclusi

REF.	CODE	L	L ₁	F	kg	
MCD' HSK-A63 F.26 RL DIN69893	71HSKA63F026RL1	PCLNR/L 065.12	65	39	45	0.8
		PDJNR/L 070.15	70	44		
		SVHBR/L 065.16	65	39		

- TURNING BIT-HOLDERS
- DREHSITZE
- ASIENTOS DE TORNEADO
- LOGEMENTS DE TOURNAGE
- SEGGI DI TORNITURA

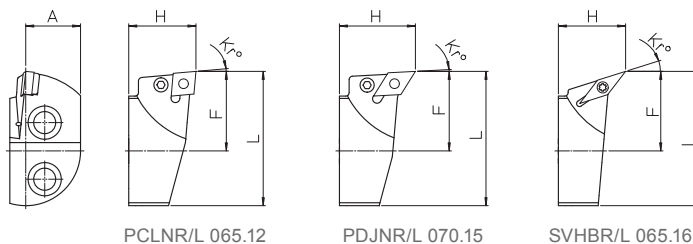

- Right hand bit-holders shown: 1) Side cutting edge angle. 2) True rake angle. 3) Cutting edge inclination
- Rechte Plattenhalter abgebildet: 1) Einstellungswinkel. 2) Obere Freifläche. 3) Neigungswinkel
- Asientos derechos en la figura: 1) Ángulo de registro. 2) Ángulo de desmoldeo superior. 3) Ángulo de inclinación
- Dans la figure les logements droits: 1) Angle d'enregistrement. 2) Angle de dépouille supérieure. 3) Angle d'inclinaison
- In figura seggi destri: 1) Angolo di registrazione. 2) Angolo di spoglia superiore. 3) Angolo di inclinazione

REF.	CODE	A	F	H	L	K _r ¹⁾	γ ²⁾	λ ³⁾				kg
MCD' PCLNR 065.12	7501PCLNR065121	31	45	38	76	5°	6°	6°	CNM..1204..	-	-	0.4
MCD' PCLNL 065.12	7501PCLNL065121											
MCD' PDJNR 070.15	7501PDJNR070151			43		3°	DNM..1506..	0.35				
MCD' PDJNL 070.15	7501PDJNL070151											
MCD' SVHBR 065.16	7501SVHBR065161			38		17°30'	0°	0°	VBM..1604..	DMC US63	TORX 15	0.3
MCD' SVHBL 065.16	7501SVHBL065161											



- TURNING TOOLS
- DREHENWERKZEUGE
- UTENSILIOS PARA TORNEADO
- OUTILS DE TOURNAGE
- UTENSILI DI TORNITURA

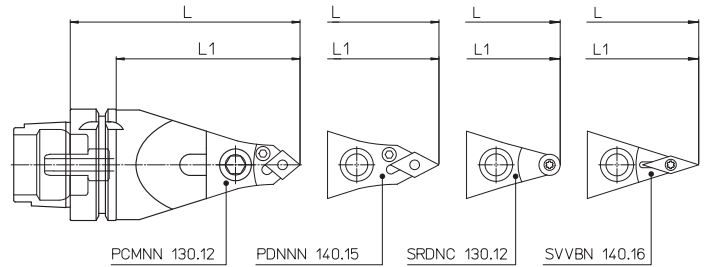

- Supplied with coolant tube. Without bit-holders and clamping wrenches
- Lieferung inklusive Kühlmittelrohr. Sitze und Anzugsschlüssel nicht inbegriffen
- Completo con racor para el refrigerante. No incluye los asientos ni las llaves de apriete
- Pourvu de raccord pour liquide d'arrosage. Logements et vis de serrage exclus
- Completo di raccordo per il refrigerante. Seggi e chiavi di serraggio esclusi

REF.	CODE	L		L ₁	kg
MCD' HSK-A63 F.77 N DIN69893	71HСКА63F077N01	PCMNN 130.12	130	104	1.7
		PDNNN 140.15	140	114	
		SRDCN 130.12	130	104	
		SVVBN 140.16	140	114	

- TURNING BIT-HOLDERS
- DREHSITZE
- ASIENTOS DE TORNEADO
- LOGEMENTS DE TOURNAGE
- SEGGI DI TORNITURA

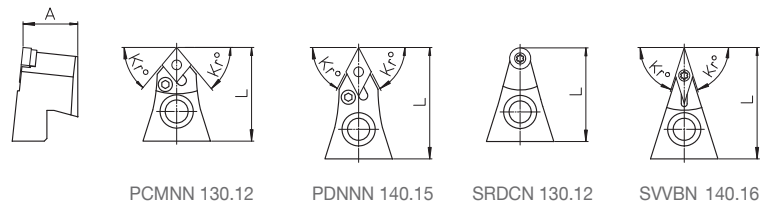

- 1) Side cutting edge angle. 2) True rake angle. 3) Cutting edge inclination
- 1) Einstellungswinkel. 2) Obere Freifläche. 3) Neigungswinkel
- 1) Ángulo de registro. 2) Ángulo de desmoldeo superior. 3) Ángulo de inclinación
- 1) Angle d'enregistrement. 2) Angle de dépouille supérieure. 3) Angle d'inclinaison
- 1) Angolo di registrazione. 2) Angolo di spoglia superiore. 3) Angolo di inclinazione

REF.	CODE	A	L	K _r ¹⁾	γ ²⁾	λ ³⁾				kg
MCD' PCMNN 130.12	7505PCMNN130121	31	53	50°	6°	0°				0.2
MCD' PDNNN 140.15	7505PDNNN140151		63	62°30'						
MCD' SRDCN 130.12	7505SRDCN130121		53	-	0°	0°				
MCD' SVVBN 140.16	7505SVVBN140161		63	72°30'						

145-212

216

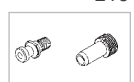

- EXTERNAL TURNING TOOL HOLDERS
- ADAPTER FÜR WERKZEUGHALTERUNGEN
- ADAPTADORES PORTA-HERRAMIENTAS
- ADAPTEURS PORTE OUTILS
- ADATTATORI PORTAUTENSILI

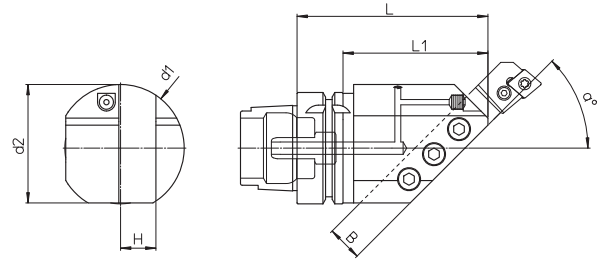

- Right hand tool holder shown. Supplied with coolant tube. Without bit-holders and clamping wrenches. A standard application requires left hand tools with right hand adapters.
- Adapter für Drehklemmhalter. Lieferung inklusive Kühlmittelrohr. Werkzeuge und Anzugsschlüssel nicht inbegriffen. Die normale Anwendung erfordert ein linkes Werkzeug in einem rechten Adapter.
- Adaptadores porta-herramientas. Completo con racor para el refrigerante. No incluye los asientos ni las llaves de apriete. El uso normal requiere una herramienta izquierda en una adaptador derecho.
- Adapteurs porte outils. Pourvu de raccord pour liquide d'arrosage. Logements et vis de serrage excus. L'utilisation normale nécessite un outil gauche dans un adaptateur droit.
- In figura portautensile destro. Completo di raccordo per il refrigerante. Seggi e chiavi di serraggio esclusi. L'utilizzo normale richiede un utensile sinistro in un adattatore destro.

REF.	CODE	L	L1	d1	d2	a	BxH	kg
MCD' HSK-A63 TU20.45R DIN69893	71HSKA63T2045R1	108	82	72	67	45°	20x20	2.7
MCD' HSK-A63 TU20.45L DIN69893	71HSKA63T2045L1							

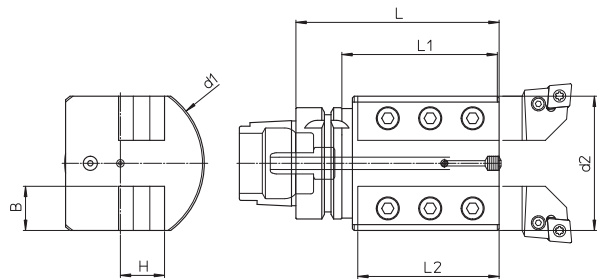

- Supplied with coolant tube. Without bit-holders and clamping wrenches
- Lieferung inklusive Kühlmittelrohr. Werkzeuge und Anzugsschlüssel nicht inbegriffen
- Completo con racor para el refrigerante. No incluye los asientos ni las llaves de apriete.
- Pourvu de raccord pour liquide d'arrosage. Logements et vis de serrage excus
- Completo di raccordo per il refrigerante. Seggi e chiavi di serraggio esclusi

REF.	CODE	L	L1	L2	d1	d2	BxH	kg
MCD' HSK-A63 TU25.02N DIN69893	71HSKA63T2502N1	115	89	90	95	76	25x25	3.0

216

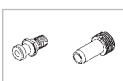

213



- **EXTERNAL TURNING TOOL HOLDERS**
- **ADAPTER FÜR WERKZEUGHALTERUNGEN**
- **ADAPTADORES PORTA-HERRAMIENTAS**
- **ADAPTEURS PORTE OUTILS**
- **ADATTATORI PORTAUTENSILI**

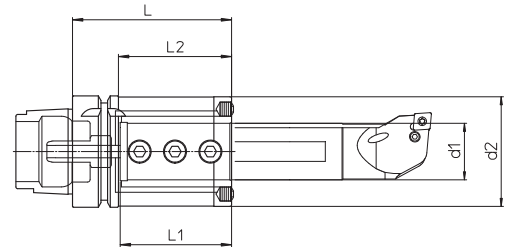

- Supplied with coolant tube. Without bit-holders and clamping wrenches. **Reduction bushes on request.**
- Lieferung inklusive Kühlmittelrohr. Werkzeuge und Anzugsschlüssel nicht inbegriffen. **Einsatzhülse auf Anfrage.**
- Completo con racor para el refrigerante. No incluye los asientos ni las llaves de apriete. **Casquillos reductores bajo pedido.**
- Pourvu de raccord pour liquide d'arrosage. Logements et vis de serrage exlcus. **Doilles de réduction sur demande.**
- Completo di raccordo per il refrigerante. Seggi e chiavi di serraggio esclusi. **Bussole di riduzione a richiesta.**

REF.	CODE	d ₁ ^{H5}	d ₂	L	L ₁	L ₂	kg
MCD' HSK-A63 D.32x64 DIN69893	71HСКА63D326401	32	62	90	64	64	2.3
MCD' HSK-A63 D.40x85 DIN69893	71HСКА63D408501	40	80	125	85	93	2.5

MCD'

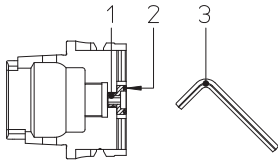

REF.	CODE 1	CODE 2	CODE 3
MCD' HSK-A63 F.26 RL DIN69893	20 146 211 0155	10 125 1 002043	10 150 01 0 1000

MCD'

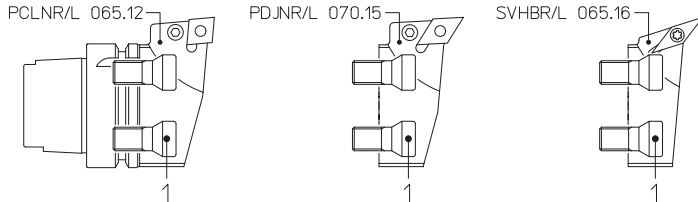

REF.	CODE 1
MCD' HSK-A63 F.26 RL DIN69893	20 010 017 1220

MCD'

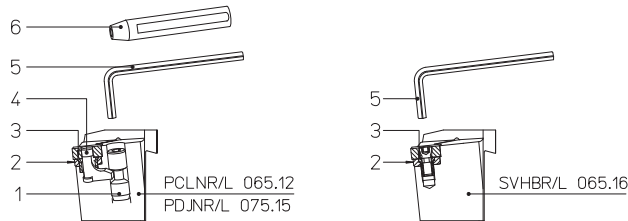

REF.	CODE 1	CODE 2	CODE 3	CODE 4	CODE 5	CODE 6
MCD' PCLNR/L065.12	49 43 1 0080230	49 20 3 0003012	10 065 5 065 060	49 11 1 0000002	10 150 01 0 0400	10 150 13 0 7100
MCD' PDJNR/L 070.15	49 43 1 0080260	49 20 3 0003015		49 11 1 0000003		
MCD' SVHBR/L 065.16	-	49 20 3 0003016	49 20 1 0000508	-	10 150 01 0 0350	-

MCD'

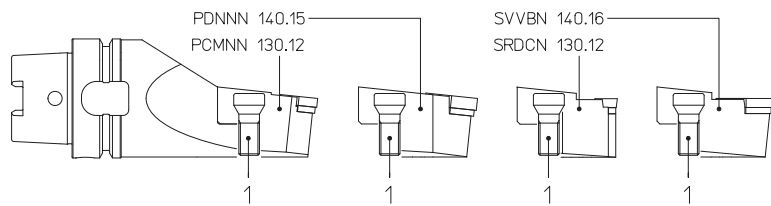

REF.	CODE 1
MCD' HSK-A63 F.26 RL DIN69893	20 010 017 1220

MCD'

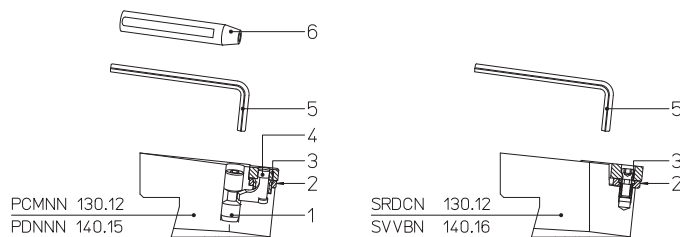

REF.	CODE 1	CODE 2	CODE 3	CODE 4	CODE 5	CODE 6
MCD' PCMNN 130.12	49 43 1 0080230	49 20 3 0003012	10 065 5 065 060	49 11 1 0000002	10 150 01 0 0400	10 150 13 0 7100
MCD' PDNBN 140.15	49 43 1 0080260	49 20 3 0003015		49 11 1 0000003		
MCD' SRDCN 130.12	-	49 20 3 0003013	49 20 1 0000508	-	10 150 01 0 0350	-
MCD' SVVBN 140.16	-	49 20 3 0003016				



- ACCESSORIES AND SPARE PARTS
- ZUBEHÖRTEILE UND ERSATZTEILE
- ACCESORIOS Y PIEZAS DE RECAMBIO
- ACCESSOIRES ET PIÈCES DETACHÉES
- ACCESSORI E PARTI DI RICAMBIO

MCD'

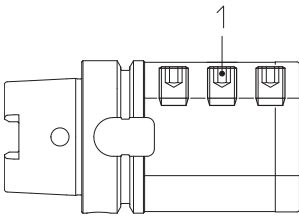

REF.	CODE 1
MCD' HSK-A63 TU20.45R DIN69893	10 023 1 120 025
MCD' HSK-A63 TU20.45L DIN69893	

MCD'

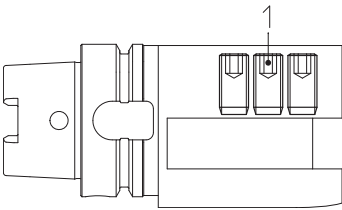

REF.	CODE 1
MCD' HSK-A63 TU25.02N DIN69893	10 023 1 120 025

MCD'

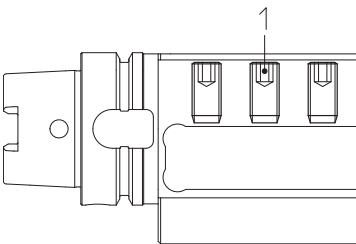

REF.	CODE 1
MCD' HSK-A63 D.32x64 DIN69893	10 023 1 120 016
MCD' HSK-A63 D.40x85 DIN69893	